

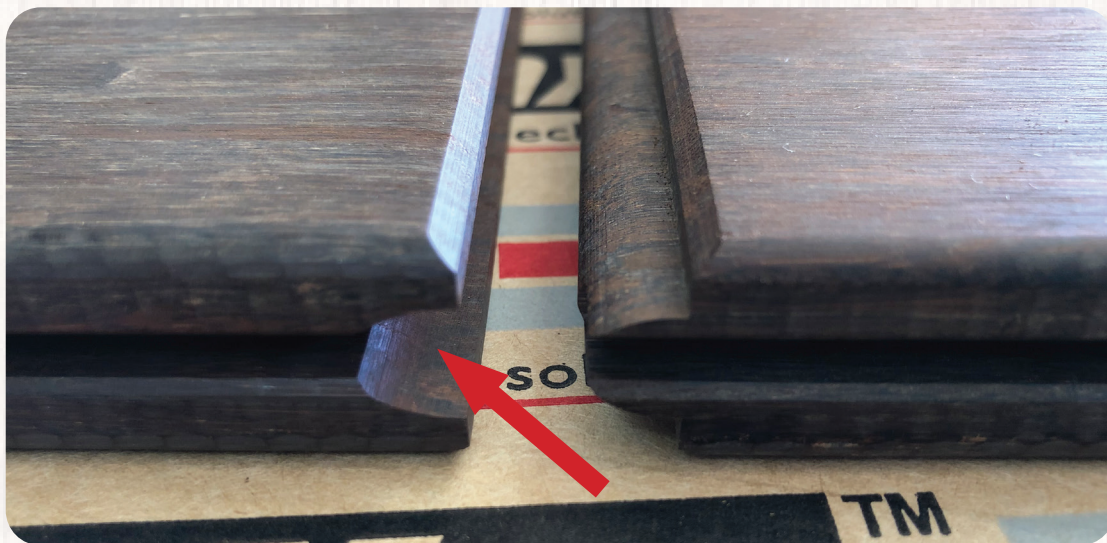

Deck-Max Bamboo Installation Data Sheet

Installation tips and Recommended instructions.

- SPECIFICATION: 1850mm x 137mm x 20mm
 - o Pre-grooved both sides
 - o End matched – not required to cut and join on joists



- o Janka Hardness – 3,820 lbf Janka Rating – Twice that of Merbau 118mpa
- o Bal 29 – Fire rating
- Joist Centres 350mm max 450mm (the closer the joists are the more rigid the deck boards will be)
 - o If laying on the diagonal, then Joists should be closed up to 300mm.
 - o Recommended 45mm wide joists
 - o Frame should be built with noggins at no more than 800mm apart
 - o Be sure all end grains of frame cuts are sealed with an exterior primer paint
 - o It is recommended that the top of all framing be treated with the same exterior primer paint.
 - o We DO NOT recommend the rubber flashing or other rubber materials on top of joists - You are welcome to email us to discuss this issue.

Refer to the Woca Coating data sheet - you can coat like normal hardwood. It takes the best of Composite (Wood Plastic) & (Hardwood) to deliver the most stable material in the world. Perfect for Decks close to ground



Note: You can layup the Ultra set on the bottom lip of the receiving end of the end matching - see red arrow on the image above.



RESIDENTIAL AND COMMERCIAL APPLICATIONS



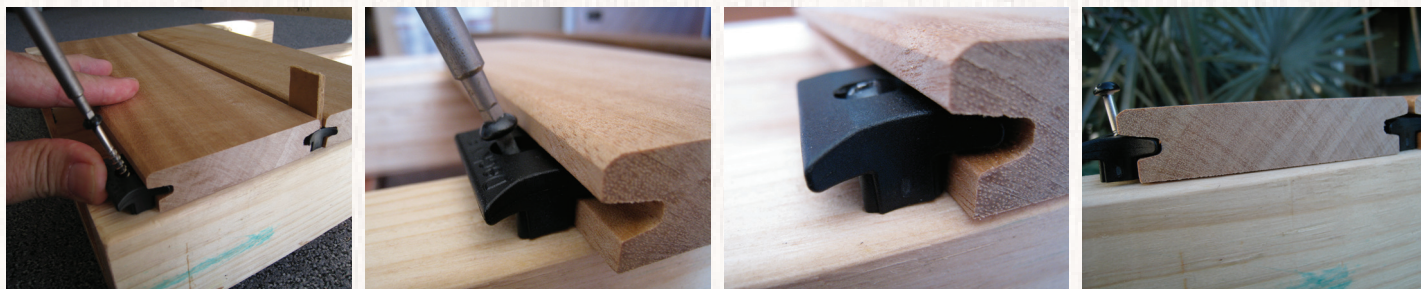

- Clips and screws:
 - The boards are pre-grooved to receive the Deck-Max hidden fastener.
 - Clip and screw are made of 304 Stainless Steel – powder coated.
 - ONLY use the Deck-Max clips and screws provided – any alternative fixing used will void any warranty claims.
 - Clips should be pushed firmly into the groove on the side of the board and retained in that position while fixing the screw.
 - Insert the screw - See steps above for correct fixing, see on live videos under Pro Clip.
 - We will supply Bostik UltraSet to lay up on top of the joist to provide an acoustic membrane to remove the rattle and squeak.
 - Depending on the sub frame you may require pre drilling prior to fixing the screw
 - Do not over drive the screw when fixing. If you have a problem engaging the next board then you may have over tightened the screw into the clip and or have not kept the clip tight into the groove therefore creating a wider gap setting than the others.
 - Be sure to only use the correct driver bit to match the screws
 - Do not fix screws with fast speed or you run the risk of breaking the screw and or burring the rebate on top of the screw.
 - Be sure to insert the driver bit firmly into the head of the screw prior to fixing so you do not bur the head. Use the Deck-Max 100mm #2 sq. driver bit. See photo steps above for simple installation of the clip & screw.
- Cutting tools:
 - It is recommended that a fine-tooth blade be used for a finer cut
 - Blades with more teeth is recommended say a 60 tooth on a 180>200mm blade.
 - When cutting any ends, it is best practice to seal all cut ends – failure to do so will void any warranty.
- Clamping of boards:
 - During installation it is recommended that Decking clamps be used to maintain the gap setting.
 - If tapping board into position ONLY use a rubber mallet or tap to another piece of timber BUT do not hit the side of the board directly with a hard hammer.

dasso.XTR Features



Environment-friendly



Termite-resistant



Fire-proof



High stability



High Density



High hardness



15-year durable



Corrosion-resistant



Mould-resistant



Good dimension stability



RESIDENTIAL AND COMMERCIAL APPLICATIONS





Image # 1

Apply Polyurethane in a thick bead the width of each board.

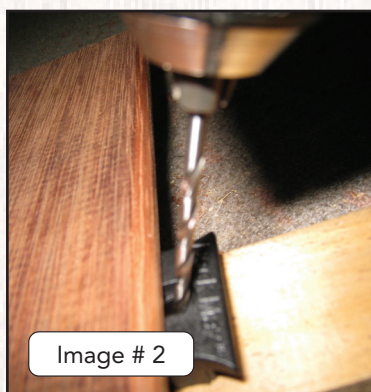

Image # 2

If required run a pilot hole for the perfect fit with a 3mm drill bit for pine joists and maybe a 4mm drill bit for hardwood.



Image # 3

Use clamps to pull boards in tight and also retain board down to the frame prior to fixing the clips.

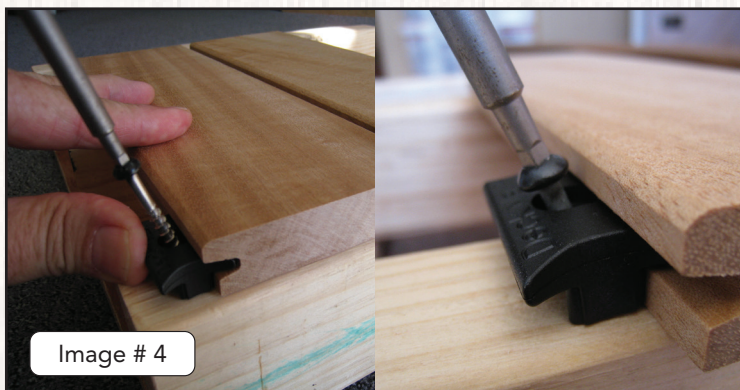

Image # 4

Be sure to hold the clip firmly into the groove while fixing the screw. Insert Screw at the 5 to 10-degree angle to avoid bushing the top side of the board. Fasten the screw head into the rebate but do not over tighten.

Best Practice Tips

1. Refer to the data sheet for "Decks Close To Ground" by Deck-Max.
2. Apply dark coloured Timber Primer paint to the top of the joists as a layer of protection from rot.
3. Insert noggins to stiffen up frames that are often not inserted in both steel & timber frames. This prevents the framing twisting and creating an unstable sub frame. See image below.

** If in doubt on any aspects of this system call Deck-Max for advise.*



Note: When fixing Deck-Max™ - always follow the joists as your point of fixing as in many cases the joists may run off at angles. Simply insert a Deck-Max™ when ever the board intersects with a joist. Deck-Max™ is a proprietary system and must be installed as per manufacturer's specifications. Deck-Max™ does not warrant the board or sub structure. Always use the necessary safety equipment and protective ware.



Butt Joints - Mitred Corners - Framing Boards see diagram # 2, #3 & # 4 below.

Joiner Biscuit see diagram # 1 - Using a biscuit cutter insert the cut / kerf into the face of the join as in Diagram # 2. Be sure cut is same on both timbers that you are joining – test run your settings and measurements before starting. Insert biscuit cut to both faces / end same as side lateral cut [set/hold board with clamp so it does not spin off with the direction of the biscuit cutter] Use one per 90 mm butt joint, Use two per mitre – Use two on each joint of wider boards like the 140 mm. You will fit the Deck-Max™ in its normal manner on the side plus the butt joiner as in diagram # 2. Insert glue [same as used on joists] then fit biscuit tap butt joint tight and fix – clean off all excess glue that appears on the deck surface. Mitred corners and framing boards – use the Deck-Max™ joiner.

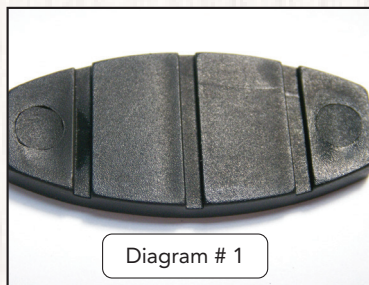

Diagram # 1

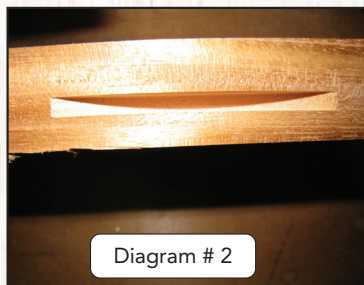

Diagram # 2



Diagram # 3



Diagram # 4

Wood Plugs and Counter Bore Tool



1



2



1

Counterbore Tool

2

Counterbore Tool Assembly

3

Counterbore Tool Allen Key Adjustability

4

Wood Plug and Screw for Timber or Metal Frame



3



4



Click the link to see **Wood Plug Kit - Hardwood**



Decking Clamps

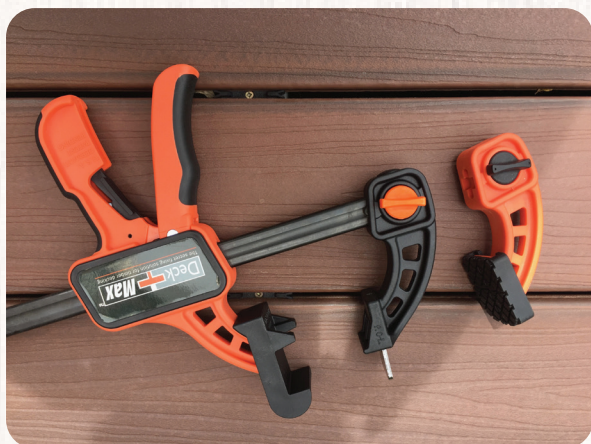

These Deck Clamps are essential for keeping the gap setting as you install the boards. See videos on the website.

- Spacing off buildings / walls:
 - o Follow local codes and pest inspection guidelines to set back off walls when building close to a wall
 - o Some codes require pest inspections – use local guides for this guide.
- Storage prior to installation: Bamboo should be kept from direct sunlight, and inclement weather before installation.
- Follow best practice for Decks Close to ground – refer to Deck-Max technical data Sheets for specifications.
 - o If decks are built close ground and the guidelines of the Technical data sheets referred to are not followed the warranty is Void.
- All deck constructions must be built to the building code of your area.
- It is the sole responsibility of the purchaser that all codes are adhered to.

Finishing:

- When you approach the last few boards you will need to possibly rip a board lengthways to trim to wall.

Start and Finish Tools:

- CounterBore tool and or the Counter Sink tool can be used in conjunction with each other.
- The CounterBore tool matched with the screw and Specific Plug are the recommended fixing options and please review the product on the website for clear instructions.
- The CounterBore tools are matched with the wood plug and screws in our recommended inclusions. Use for face fixing Fascia as well.



RESIDENTIAL AND COMMERCIAL APPLICATIONS

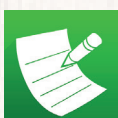

Note: After preparing the board with either tools - You MUST run a 3.5 or 4mm Long shank drill bit into the same hole to ensure the screw does not break as the bamboo is so hard. We recommend a trial before doing the on main area.

Fascia - grooved one side only Boards

- When designing the fascia / Riser board here are 3 x options.
- Dasso does provide a board groove one side only.
- In Option A this single sided grooved board would be used on the last board on the top.
- In Option B this single sided grooved board would be used on the Front and set flush to the top of the decking boards.
- Or in Option C – Mitre the corners.

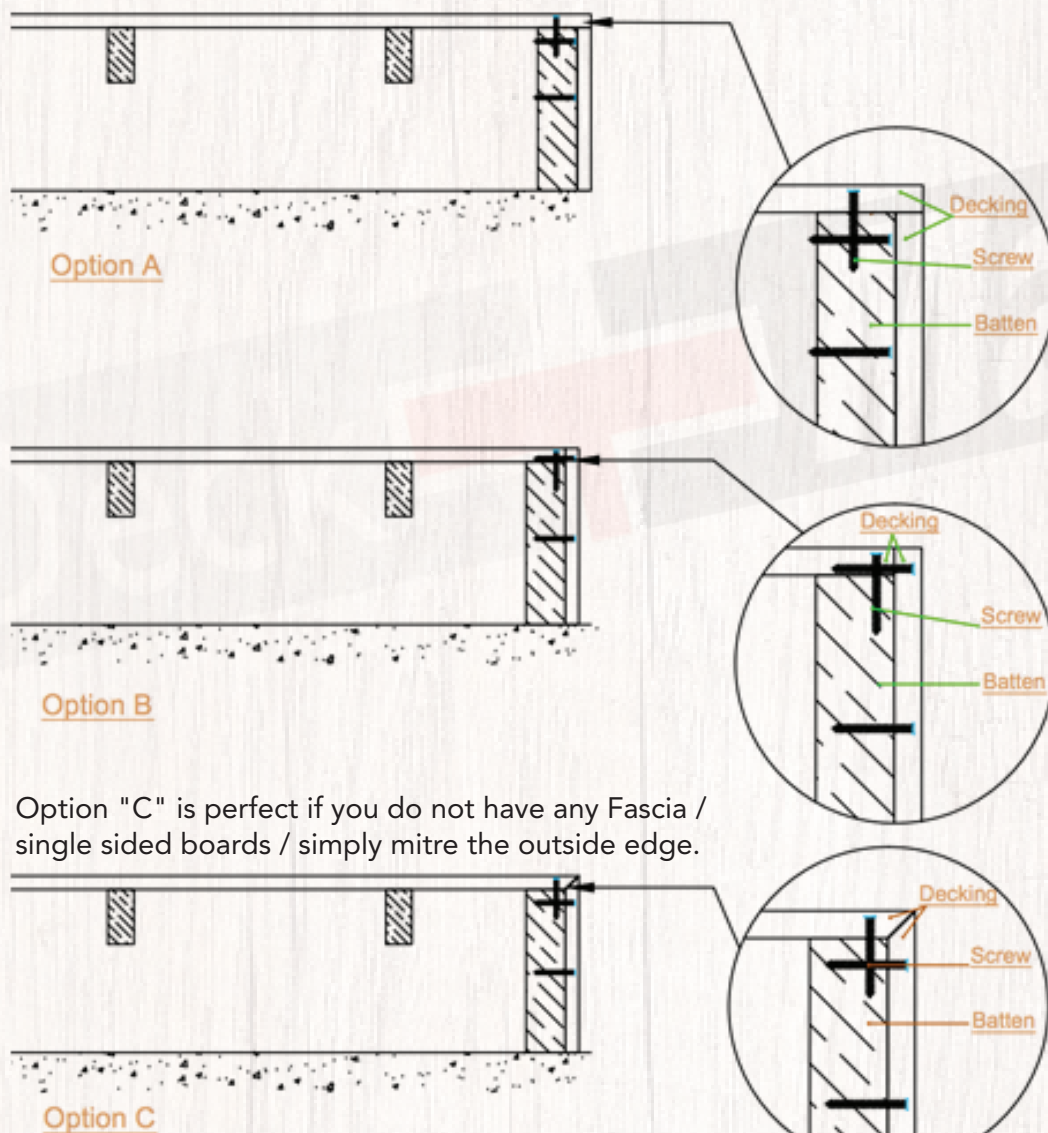

Finish as per Diagram "A" using wood Plugs



RESIDENTIAL AND COMMERCIAL
APPLICATIONS



See below for layout ideas when laying short boards

Layout # 1 - Picture Framed Staggered pattern / centre to centre

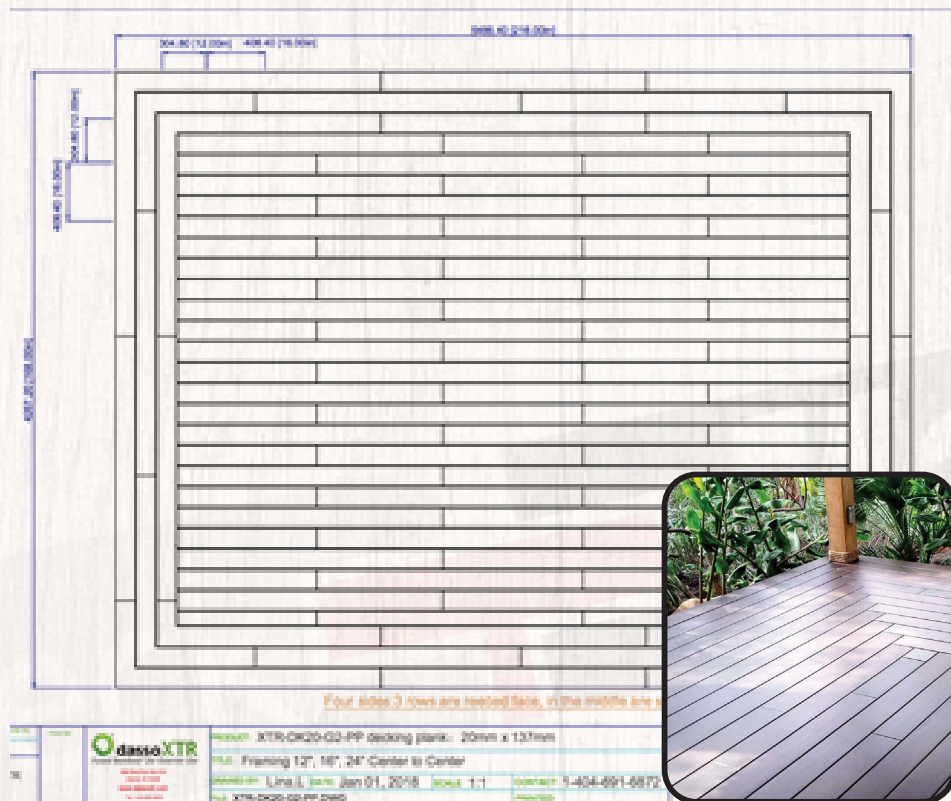

Layout # 2 - Staggered Pattern / centre to centre

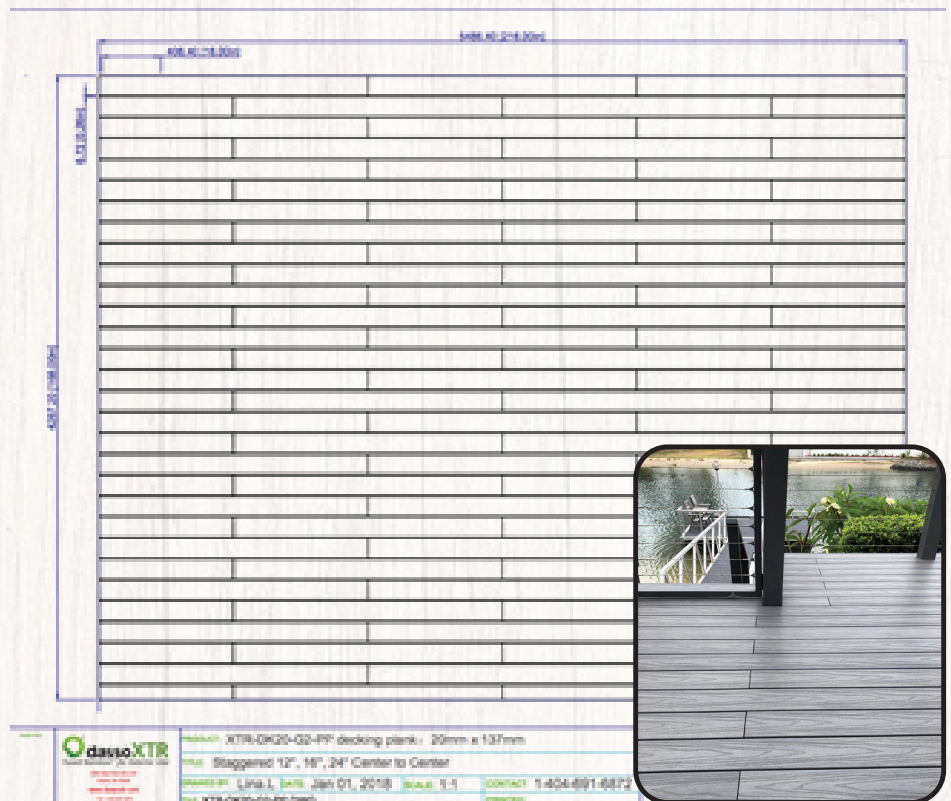

RESIDENTIAL AND COMMERCIAL
APPLICATIONS



Layout # 3 - Staggered based on Joist centres



Care and Coatings

The Dasso material is supplied in what we call a raw board providing you with 2 x options.

Option # 1 - After installation it is recommended that 2 x coats of the Woca oil be applied - See Woca Data Sheet. If after the initial coatings you may choose to let it fade noting that bamboo is similar to hardwood that is not coated - The texture can vary and silvering will occur. To clean simple wash with a light detergent and soft broom - rinse off with water and a wide Squeegee is best to remove the surface water or you can get small water marks on the surface.



Note: Protect decking during installation - lay down rubber matting and keep all other trades off the decking.

Option # 2 - Refer to manufacturer for coating information.



Note: Follow all manufacturers direction and advises as offered by them. The timing between coatings will depend on the location and climate you are in. Dasso provide a 25 year Limited Warranty.



Note: All these are natural variations to natural materials; environmental conditions, such as air pollution, mold, mildew, etc., or staining from foreign substances such as dirt, grease, oil, etc.; Normal weathering from sunlight, weather and atmosphere, causing color change, checking, grain raise/splintering, cupping and other forms of movement; variations and degradation in color/grain.



RESIDENTIAL AND COMMERCIAL APPLICATIONS



Key Benefits

- No Nails & Screws in the surface (Secret Fixing system)
- Can leave to go grey or coat to keep looking smart.
- Fire Rating - Bal 29
- 90% harder than Merbau
- 70% less waste
- 30% faster to Install
- End Matched - to join between joists
- 50% less movement than Merbau
- No gaps to butt joints
- Stable when close to ground or near Moisture

Other Products

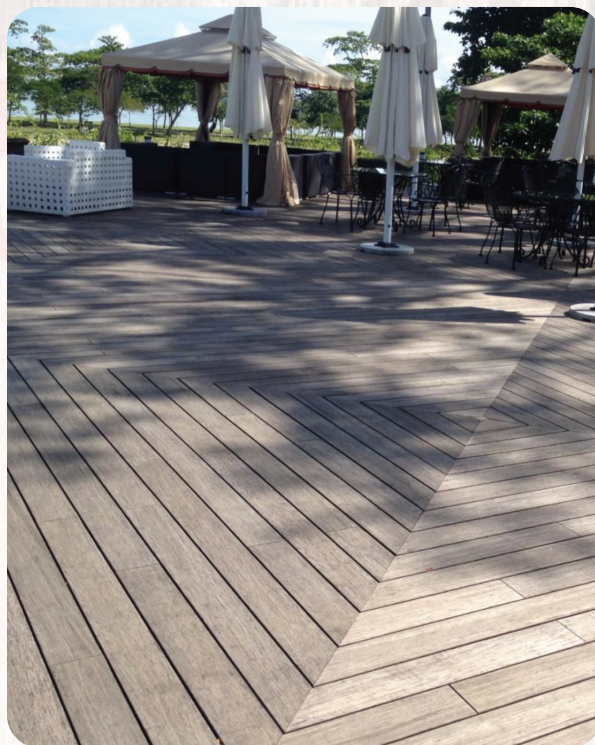

- Exterior wall cladding
- Soffit Lining
- Patio flooring (T&G) no gap decking

All available in 2 colours

- XTR (Mahogany tone)
- Epic (Spotted Gum tone)



RESIDENTIAL AND COMMERCIAL
APPLICATIONS

